

AHT 
a member of **DAIKIN** group

FIXWELL
www.fixwell.com.hk



MANHATTAN

_Refrigerators and freezers. Plug-in installation

Innovative and sophisticated.

The sliding cover system is impressively easy to use and is divided lengthwise, allowing products to be accessed from both sides. This variability offers completely new opportunities at the POS and makes the MANHATTAN the flexible all-rounder in individual or in-line placement.



VISUAL MERCHANDISING

Thanks to its deeply curved, specially coated glass cover, MANHATTAN offers excellent visibility of the goods on display. Products can be removed from both sides, thanks to the cover system divided lengthwise. Thanks to the height- and width-adjustable product racks and the LED interior lighting, products can be presented perfectly. The smallest of footprints means that in-line installation is also possible.



HIGH ENERGY SAVINGS

Save even more compared to conventional multi-unit systems, thanks to the sophisticated technology and design with AHT e-conomize. The electronically controlled, variable-speed compressor (VS) reduces power consumption by 25%. In addition, the new energy-saving fan saves 0.5 kWh every day.



ENVIRONMENT AND CLIMATE

MANHATTAN units are completely CFC- and HFC-free and use the ecologically harmless and natural refrigerant propane (R290). R290 has the lowest GWP on the market. This makes them particularly environmentally friendly.



LOW COSTS

The low investment outlay and operating costs speak for themselves. In addition, the outer-skin condenser on MANHATTAN provides for completely maintenance-free refrigeration.



INTELLIGENT INSTALLATION

Ready-to-connect installation means MANHATTAN can be used immediately.



SEMI-AUTOMATIC DEFROSTING

Semi-automatic defrosting is possible in all temperature ranges. The constant temperature and high-quality plastic containers mean that the shelf life and hygiene of all products are always ensured. The plastic interior drip tray guarantees easy cleaning.



COMPATIBLE WITH AMS

Our Active Monitoring System (AMS) allows us to detect problems before you notice them. As an essential add-on to all AHT products, the AMS makes it much easier for you to manage and monitor the AHT cooling systems in your stores.

INDIVIDUAL BRANDING

AHT cooling units are constructed individually: Using our template, you create the design, then we apply it directly during production.



TEMPERATURE RANGES

| | |
|-------------------------|----------------------------|
| Cooling | +3°C to +15°C ¹ |
| Freezing | -18°C to -23°C |
| Mincemeat/meat chilling | 0°C to +2°C |

¹ Fixed preset that can be changed by a service technician

USPs

MAXIMUM EASE OF USE

The four glass sliding doors allow MANHATTAN to be opened from every side. You can easily attach price displays to the central divider.

MAXIMUM SIZE

With a net volume of 814 litres, MANHATTAN 210 provides plenty of space for your products. In practical terms, this means that you can accommodate three frozen pizzas, one behind the other.





MANHATTAN 175



MANHATTAN 210

CONFIGURATIONS

Solo

Row



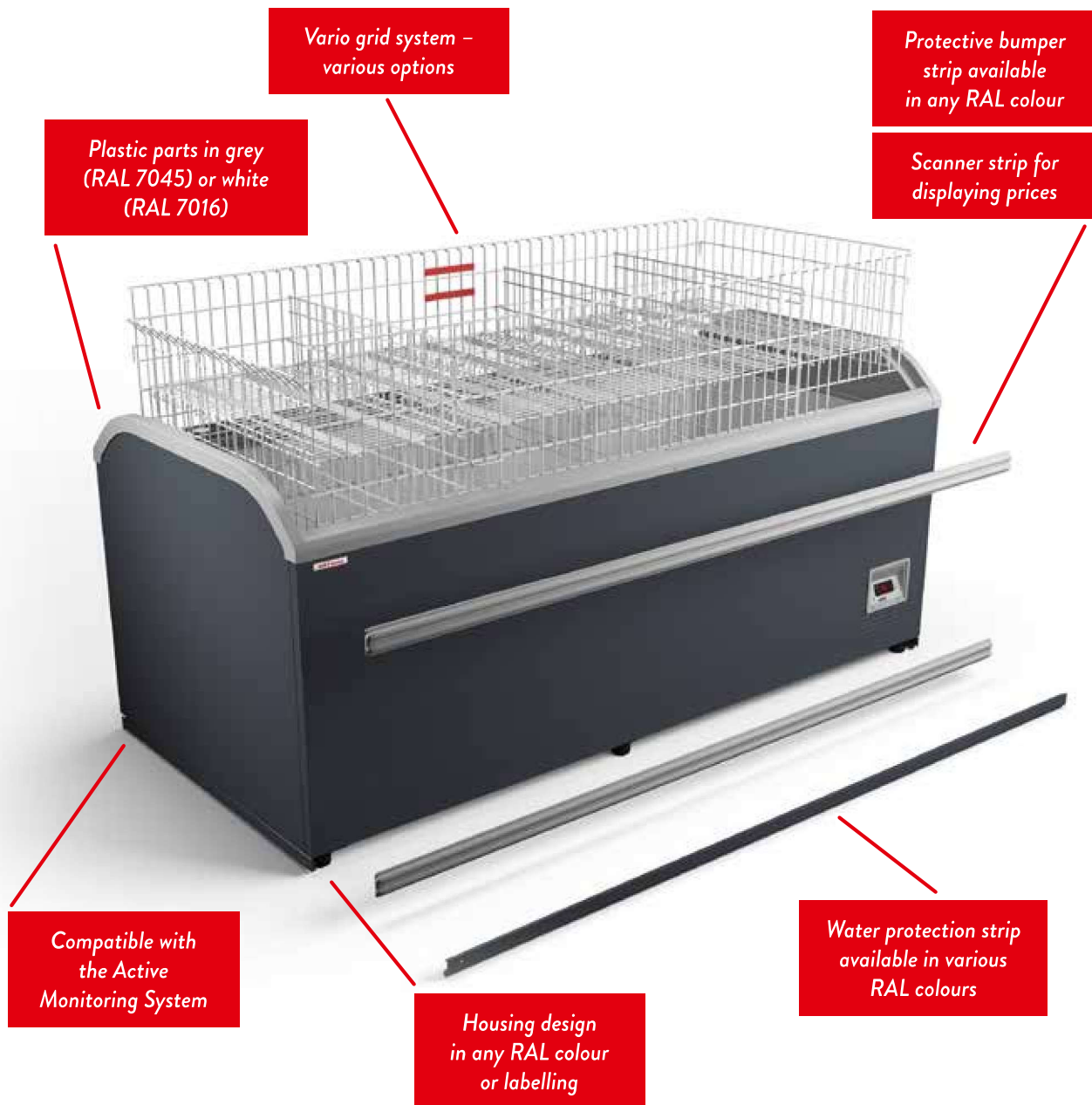

ACCESSORIES

- _ Scanner strip
- _ Water protection strip (colour change on customer request)
- _ Optionally with rollers (picture of the rollers)
- _ Vario grid system (rack inserts & wire dividers), baskets
- _ Colour and styling options tailored to customer requirements (housing, protective bumper strip, plastic parts in 2 standard colours)
- _ Compatible with the Active Monitoring System (AMS)

MANHATTAN

175 / 210

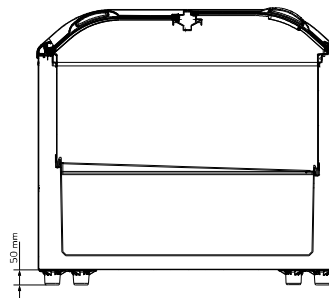
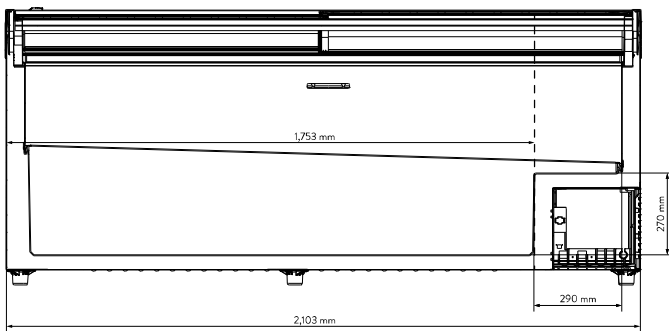

DIMENSIONS

| MANHATTAN | | | 175 | | 210 |
|-------------------------------|----|--|---------------|--|---------------|
| Length, exterior / interior | mm | | 1,753 / 1,623 | | 2,103 / 1,973 |
| Depth, exterior / interior | mm | | 995 / 863 | | 995 / 863 |
| Height, front / rear | mm | | 804 / 910 | | 804 / 910 |
| Stacking height, front / rear | mm | | 560 / 560 | | 560 / 560 |

Subject to technical changes; errors and omissions excepted. Version: 01/2022



AHT Cooling Systems GmbH

Werksgasse 57
 8786 Rottenmann | Austria
 p. +43 3614 24 51-000
 sales@aht.at
 www.aht.at



Fixwell Display System Co, Ltd

Unit 1401, Westlands Centre,
 20 Westlands Road, Quarry Bay, Hong Kong.
 tel.: +852 2811 9381
 e-mail: sales@fixwell.com.hk
 www.fixwell.com.hk